

HYDRA @ BEAUTYTM



Operator Manual

Ver. 1

© 2017 EUNSUNG GLOBAL CORP.

This manual is copyrighted with all rights reserved. This manual may not be copied in whole pages or in part reproduced such as graphic, electronic, mechanical, including photocopying, typing, or information retrieval systems without written permission of EUNSUNG GLOBAL.

The system specifications and the information contained in this manual book are subject to change without notice.

EUNSUNG GLOBAL CORP.

**120, Gieopdosi-ro, Jijeong-myeon, Wonju-si,
Gangwon-do, Republic of Korea**

Tel. : +82-2-514-9713

Fax. : +82-2-514-9716

E-mail : es@esglobal.co.kr

Website : www.esglobal.co.kr

Manufactured by EUNSUNG GLOBAL CORP.

**120, Gieopdosi-ro, Jijeong-myeon, Wonju-si,
Gangwon-do, Republic of Korea**

Tel. : +82-2-514-9713

Fax. : +82-2-514-9716

E-mail : es@esglobal.co.kr

Website : www.esglobal.co.kr

Authorized representative:

EUNSUNG GLOBAL CORP.

**120, Gieopdosi-ro, Jijeong-myeon, Wonju-si,
Gangwon-do, Republic of Korea**



Contents

1. Product overview

1.1 General subjects.....	5
1.2 Marking used in the manual and equipment.....	5

2. Safety Precautions

2.1 Outlines.....	6
2.2 General precautions	6
2.3 Power Risk Precautions.....	6
2.4 Fire Risk Precautions	7
2.5 Precautions for Cleaning.....	7
2.6 Regulations.....	7
2.7 Taboo	7

3. Product composition

3.1 Product structure.....	8
3.2 Components.....	9

4. Installation of the product

4.1 Outlines.....	10
4.2 Handpiece installation.....	10
4.3 Handpiece decomposition.....	13
4.4 installation of the body & solutions.....	14
4.5 Cleaning & replacement for solution filters.....	15
4.6 installation of the body & waste container.....	16
4.7 Power supply.....	16

Contents

5. How to use

5.1 Outlines.....	17
5.2 Precaution before using.....	17
5.3 Screen & Control board.....	18
5.4 The way to use the device.....	19
5.5 Large waste container.....	23

6. Maintenance

6.1 Outlines.....	24
6.2 Cleaning.....	25
6.3 Storage	25
6.4 Checking before reporting the fault.....	25

7. Warranty

7.1 Outlines.....	26
7.2 Guarantee for free.....	26
7.3 Exclusions within free warranty period.....	26
7.4 Compensatory guarantees.....	26

8. Product specifications..... 27

9. Customer services / Sales..... 27

1. Product overview

1.1 General subjects

- The system for Hydrabeauty is designed to meet the international standard for medical devices, so it is secure, rugged, and easy to use. Please keep the basic maintenance list such as handpiece tip replacement, proper cleaning and so on.

1.2 Marking used in the manual and equipment

Marking	내 용
	Warning In case of violating instructions or serious injury or danger
	Caution Any violation of the instructions could result in minor injury or damage to the product.
	Notes The case of showing something important when using the device.
	"Conformity to European" Certification Mark that it complies with European Union integration standards conditions relating to consumer safety and health, hygiene and environmental protection
	"Good Manufacturing Practices" A mark that authenticates the company's compliance with procedures and standards needed to ensure quality medical equipment is maintained on a raw material basis, through availability of quality materials, and shipment of finished products
MFDS	"Ministry of Food and Drug Safety" Certification mark that identifies a product as safe product that is licensed and compliant with the specifications of Korean Food and Drug Administration (FDA)
	The mark that shows to install the large waste container correctly
	The mark to do not drop the large waste container which can be damaged or broken.

2. Safety Precautions



Be sure to read the user manual and use it correctly.

The user manual contains instructions for use, as well as safety precautions, storage, and product warranty information. For safe use, check all of the following safety information and operating instructions before using this device. We are not responsible for personal injury or damage caused by not following any measures.

2.1 Outlines

- Be sure to read and use the instructions and instructions of use properly when using this product, and use it by someone who can perform the procedure according to the proper procedures.
- Provides basic safety precautions for the device and precautions on its operation..
- Persons who intend to work with this device should be familiar with their safety precautions.
- The equipment must be operated by appropriately trained safety personnel and must provide the correct pre-procedure precautions to those who need to be operated.

2.2 General precautions

- Be sure to check the main body and hand piece, tips, solutions, and large waste containers that you want to use before using the device.
- Install the instrument indoors in a well-ventilated place from high temperature, humidity, and direct sunlight..
 - Recommended temperature when operating : 0 - 26 °C
 - Recommended storage temperature : 0 - 35 °C
 - Relative Humidity : not more than 80 %
- Install in a well-ventilated room from away from direct sunlight.
- Install correctly on a flat surface.
- Be careful when you move the device, do not cause external shock, as this device can cause significant damage even in minor shocks.

2.3 Power Risk Precautions

- Do not use with other electric heating appliances when operating the device.
- Be careful not to get water into the device. A high pressure wet current may form, causing an electric shock or fire.
- Do not use damaged power plugs or loose outlets.
- Remove the power plug and keep it clean for a long time when not in use. This may cause an electric shock, a short circuit or a fire.
- If the device has flooded, unusual sounds, burning smells, or smoke, turn off the power immediately before calling the service center.

2. Safety Precautions

2.4 Fire Risk Precautions

- Keep flammable materials away from installation site or surrounding area of procedure
- Do not use the machine with a cover or cloth on it.

2.5 Precautions for Cleaning

- Turn off the power and do not allow water to reach the device.
- Wipe the affected area lightly with a soft cloth, and keep the handpiece and the main body clean by storing in a sanitary condition.

2.6 Regulations

- Be sure to read the user manual before using the device.
- Use genuine accessories because false one can cause device failure and, if damaged by false accessories, no charge can be obtained.
- Do not dismantle, modify or repair the appliance at will. Problems caused by random disassembly / repair are not compensated.

2.7 Taboo

- This device is a clinically validated safe device. However, please do not attempt the procedure if the patient has the following symptoms :
- Do not use the device without operator's instructions even though person has no following symptoms.
 - In case of scar or infection in the surgical area
 - Keloid
 - In case of skin diseases (catching)
 - Has a condition such as skin irritation
 - Heart disease or artificial heart transplanter



Please consider the patient's condition and the procedure environment during the procedure.

Procedures are performed with reference to the proposed procedural guidelines for this equipment, but the results may vary depending on the patient's condition and the procedure environment. Please set the procedure value and apply the procedure technique with sufficient consideration of the patient's condition before perform the procedure

3. Product composition

3.1 Product structure



3. Product composition

3.2 Composition

① Main body	② Aqua handpiece	③ EP handpiece	④ Peeling handpiece
			
	⑥ Bulk waste basket	⑤ 3types diamond peeling tips	
		 D10 / D20 / D30	
	⑥ Aqua tip large(10ea/1pack)	⑦ Aqua tip small(10ea/1pack)	
			
⑧ User manual	⑨ Fuses	⑩ Empty solution bottle 500ml * 4ea(Extra)	⑪ Handpiece cap(Extra)
			
⑫ Solution filters *4ea(Extra)	⑫ Peeling handpiece filter (100ea/1pack)	⑬ Power cable	
			



NOTE

Each component is available through contact Eunsung Global Corp.(TEL: 02-514-9713)

4. Product installation

4.1 Outlines

1. This device must be installed by an educated or licensed person in Eunsung Global Corp.
2. Before installation the device, taking into consideration its position and space, and at appropriate distances from the device or other medical device that generates heat
3. Install in well-ventilated place with good temperature and humidity and avoid direct sunlight and high humidity.

4.2 Handpiece installation

4.2.1 Aqua handpiece installation

1. Position the device main body on the flat place, match the aqua handpiece cable exactly to the right hand (when viewed from the front) connector hole and push the handpiece until an audible " click " is heard.



- Handpiece connector hole-



- Installed-

4.2.2 Peeling handpiece & EP handpiece Installation

1. Place the peeling handpiece on the left side of the main body and connect it to the connector located on the right side of the connector.
2. Align the square mark on the connector with the triangle mark on the cable and push in until an audible click is heard.
3. Place the EP handpiece on the left side of the body and connect it to the connector located on the left side of the hanger.
4. After connecting the cables, turn the locking screw to the right to fully fix it.

-Left side hanger of main body-

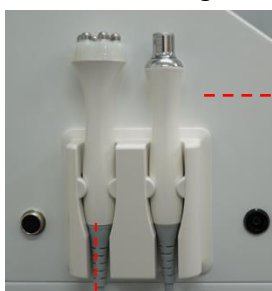

-Peeling handpiece connection-

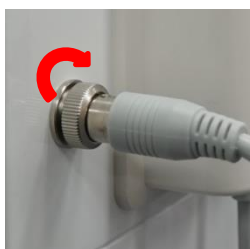

-EP handpiece connection-

4. Product installation

4.2 Handpiece installation

4.2.3 Aqua tip connection

1. Choose the tip for use and connect to the handpiece correctly.

When replacing the size of the tip, pull the tip out and connect it to the handpiece correctly with the tip you want to replace.



-Connector part-



-Tip installation-



-Correctly installed-

2. When the treatment is done, in the case of cleaning or storing, should remove the tip and apply the cap on the handpiece.



-Remove the tip-



-Applying cap-



-Correctly applied-



NOTE

Clean the hand piece cables after the solution 2 procedure using the " C " cleaning mode before do the solution 3 procedure.

After all procedures (after all 3 solutions), clean the handpiece again with cleansing mode and store it.

4. Product installation

4.2 Handpiece installation

4.2.4 Peeling handpiece tip & installation and replacement of filters

1. Place the peeling handpiece filter correctly into the connector part.
2. Select the peeling tip you want to use, match it exactly to the connector part and connect it by turning it clockwise.

When replacing the peeling tip, turn the tip counterclockwise to remove it and match the tip exactly to the connector part.

3. Please install or replace the filters and tips correctly, refer to the pictures below.



- Remove peeling tip-



- Filter replacement -



- Ready to use -

4. Product installation

4.3 Handpiece disconnection

4.3.1 Aqua handpiece disconnection

- 1. The aqua handpiece cable can be disconnected by pushing and pulling down the cable connection button.

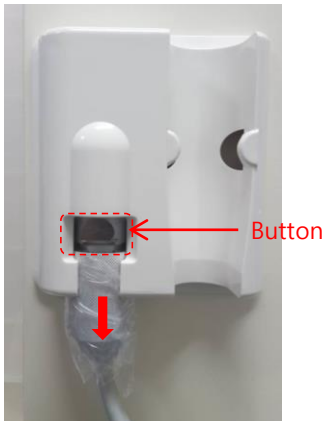

- Aqua handpiece -

4.3.2 Peeling handpiece disconnection

- 1. Remove by grabbing and pulling on the cable connector.



4.3.3 EP handpiece disconnection

- 1. Fully loosen the locking screw by turning it to the left and pull out the cable connector.



CAUTION

Follow the instruction when connecting the cable to the device. Otherwise, it will not operate properly and cause a device malfunction.

4. Product installation

4.4 Installation of main body & solution bottles

1. Open the cover at the front of the body and connect it to the connector part of solutions 1, 2, and 3, which is starting from the left, and turn the cover counterclockwise to connect each hose. Solution 1, 2, and 3 bottles are installed when the device is new. Then remove and mix the solution concentration with distilled water together and connect them to the main body.



-Place for solution1, 2, 3 -



-All 3 solutions are installed correctly-

2. Solution 4 (for clanging mode) is connected separately to the rear of the main body. After you adjust the connection part exactly, turn it counterclockwise to tighten it in order to connect it to the hose.



-Solution 4 is installed correctly-

4. Product installation

4.5 Cleaning & replacement for solution filter

- 1. Default filters are installed when the device is new.
- 2. Clean the filter every time before you replace the solution.



Lightly press the top of the filter to remove it.
Rinse in running water and pat on the flat surface.
Drain and reuse.

- 3. See the illustration below and install the filter correctly

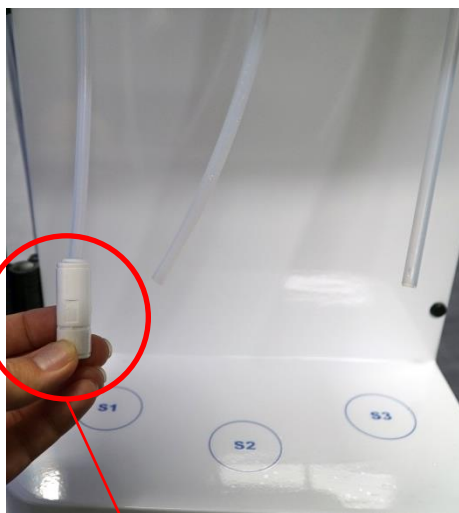

Fit the arrow on the filter
facing up.



Filter equipped appearance
(Front side of device)



Filter equipped appearance
(Rear side of device)

4. Product installation

4.5 Installation of main body & large waste container

1. Place the connection parts for installing the large storage tank (hereinafter referred to as the storage tank) in the connecting hole, and push the storage tank groove all the way to the end. When separating, hold the handle firmly and pull it lightly.



-Connection parts for waste container on the mainbody-



-Connection parts for waste container -
-



-Container has installed correctly-

4.6 Power supply

1. Connect the power cable to power socket at the rear-side of the body, and start the system by pressing the switch at the top with the switch O (OFF) and I (ON).



-Power off-



-Power on-



CAUTION

The container must be pushed fully into place to exactly coincide with the connecting parts. If not correctly installed, the valve pressure is decreased and may cause the device to be damaged.

5. How to use

5.1 Outlines

1. Details the function and use of each button to ensure proper use of the instrument, and includes cautions, and warnings in each procedure.
2. 2. Check the following before using this instrument :
 - Are the hand piece, tip, and device clean to use?
 - Is the solution correctly located?
 - Is the device secured against movement?
 - Is the power cable connected properly?

5.2 Precaution before using

1. If the vacuum level is set too high, this can have side effects.
2. Be sure to perform the procedure safely by testing before performing the procedure.

5. How to use

5.3 Screen & Control board

Screen



Control lever

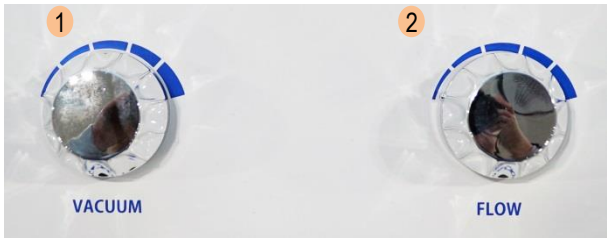

Screen	
①	Aqua handpiece selection button
②	Aqua solution selection button -1~3 : Skin treatment -C : Cleansing mode
③	Large waste container level warning indication
④	Peeling handpiece selection button
⑤	EP handpiece selection button
⑥	Procedure time display
⑦	EP level control button
⑧	Start / Stop button
⑨	System management

Control lever	
①	Vacuum level control lever
②	Solution dispensing lever

5. How to use

5.4 The way to use the device

5.4.1 Diamond peeling mode

1. When the device is turned on, the peeling handpiece selection button is selected as follows :
2. After using a different handpiece, select the diamond peeling mode by pressing the ' Peeling hand piece selection button in the screen
3. Adjust the vacuum lever on the control screen to set the vacuum level. Vacuum level can be adjusted during the procedure.
4. Press the ' start/stop ' button to start the procedure.
5. When the treatment is done, press the ' start/stop ' button to finish..



- The screen which has selected diamond peeling handpiece -



5. How to use

5.4 The way to use the device

5.4.2 Electroporation mode

1. Press the select button on the screen to select the electroporation mode
2. Adjust the level using the ' EP Level Adjustment Button '. [Default 5/ levels 1 to 10]
3. Press the ' start/stop button ' to start the procedure.
4. LED's can be selected by repeatedly pressing the ' electroporation selection button ' during the procedure. [4 kinds LED: red, blue, purple, off]
5. When the treatment is done, press the ' start/stop ' button to finish.



- The screen which has selected electroporation handpiece -

5. How to use

5.4 The way to use the device

5.4.3 Aqua peeling mode

- 1. Press the ' aqua handpiece selection button on the screen to select the aqua peeling mode.
- 2. Select the solution via the ' solutions selection button. Solution changes are not possible during the procedure. (Default : Solution 1 / All 4 solutions 1, 2, 3, and C (cleasing mode)
- 3. Use the vacuum control lever to adjust the vacuum level.
- 4. Adjust the solution flow with the flow adjustment lever. .
- 5. Press the ' start/stop button ' to start the procedure.
- 6. When the treatment is done, press the ' start/stop ' button to finish.



- The screen which has selected aqua peeling handpiece -



NOTE
[Vacuum & Flow Level Guide]

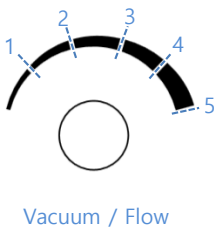

구분	Vacuum	Flow
1제	3	1
2제	3	1
3제	4	1
C모드	5(MAX)	5(MAX)

5. How to use

5.4 The way to use the device

5.4.3 Aqua peeling mode

6. How to use aqua handpiece

Start the procedure by placing the aqua handpiece tip exactly close to the skin as shown below.



-Correct-



-Incorrect-

7. Cleansing mode

Hydrabeauty offers auto cleansing mode. Choose the 'C' mode on the screen which is aqua peeling. Set the vacuum and solution flow lever to the maximum level and push the start button, then the auto cleansing mode will be started for 1min. At this moment, Aqua handpiece should be covered with cap.



-Remove the tip-



-Applying cap-



-Correctly applied-



NOTE

1. For the first treatment after the installation of the device, clean the device with cleansing mode before using. Then, set the solution quantity and suction level to the maximum level (solution level 3, suction level 5). Then, attach the tip to the back of the hand and set it for approximately 2~30 seconds to ensure smooth circulation of the required solution.
2. When the step of treatment need to be changed, set all the levels to maximum and attach the tip to the back of the hand for about 10-15 seconds, and set the tip to the level to be used.

5. How to use

5.5 Large waste container

1. Empty time for large storage containers

The waste solution during the treatment, should be wasted on certain time when the sensor has alarmed.

When the container has filled about 2.4L, there will be alarming sound and warning message on the screen. The instrument will automatically stop when a warning sign appears. In this case, empty the waste solution from the storage container before using it. It is recommended that waste fluid is emptied at regular intervals before warning sign is appeared.

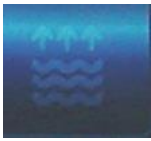

[Ordinary]



[When it is full]

2. How to open the container

When replacing or cleaning the container, turn it to OPEN direction indicated in the cap to remove it.

If the cap does not open properly or the rubber ring is damaged, replace it with a new one.



[OPEN direction]



[How to OPEN]

3. Cleaning the container

A part of metal on the inside is the water level sensor.

Recommended to use, after clearing the container, gently wipe the water level sensor with a dry cloth.

If water sensor have too much water, Full signs may appear even though the water level is not full.



[Water sensor of the container]



CAUTION

Be careful when you empty the container, since the weight of the waste solution may cause it to drop or spill the waste solution when open it.

6. Maintenance

6.1 Outlines

1. Describes self-diagnostic method, including cleaning and storage method, and error code information to maintain the device's performance.

6.2 Cleaning

1. Aqua handpiece valve management
 - ① After completing the treatment, wash the machine in the automatic cleaning mode, C. Basic washing is required to keep cleanliness from infection and germs.
2. Aqua handpiece management
 - ① Aqua handpiece is disposable.
 - ② Should waste the tip when it is used.
3. Large waste container
 - ① After the treatment, use a cleaning tool to clean the waste solution from the container under running water.
 - ② when the large waste container is filled or more than once a day, the container should be cleaned
4. Diamond peeling tip & filter
 - ① Remove the filter by separating the tip from handpiece and replace it with new one.
 - ② The removed tip should be cleaned thoroughly with an ultrasonic cleaner or a soft brush.
5. Handpiece
 - ① Wipe clean with wet towel and soft tissue after the treatment.
6. Main body
 - ① Wipe the main body and screen clean with soft towel,

6.3 Storage

1. If the product should be stored for long periods of time, turn off the power and avoid humid places..
2. When storing the product, keep handpiece, tip, and solutions separately from the main body.



CAUTION

When maintaining the device, the device must be turned off and the power cable should be disconnected.

Cleaning and storing with the power on, will cause serious damage or danger to the device.



CAUTION

The aqua hand piece tip is disposable and must be discarded after each treatment, and no liability for any problems due to reuse is provided by the Eunsung Global Corp.

6. Maintenance

6.4 Confirmation before reporting a fault

Problems	Cause of speculation	Check list
Power	Faulty power cable connection	<ul style="list-style-type: none">▪ Check ON/OFF status▪ Check connection of power cable
	Fuse	<ul style="list-style-type: none">▪ Replacement with new fuse
Vacuum	Faulty container connection	<ul style="list-style-type: none">▪ Check the connection of waste container
	Faulty handpiece connection	<ul style="list-style-type: none">▪ Check the connection of handpiece with main body
	Damage on handpiece tip	<ul style="list-style-type: none">▪ Check the damage of tip
Unusual solution Sparying quantity	Inner system clogging	<ul style="list-style-type: none">▪ Check the spraying quantity of solution1~3. If the spraying quantity of solution 1~3 is not appropriate, but cleansing mode is usual, then should doubt the problem on clogged inner system.
	Clogged handpiece	<ul style="list-style-type: none">▪ Check the spraying quantity of solution and vacuum status by set both to maximum level and check for 20-30sec▪ Check the status of the device by processing cleansing mode. If the cleansing mode is not working properly, then should doubt clogged handpiece
Unusual device performance	Full waste container	<ul style="list-style-type: none">▪ Check whether the container is full When the container has filled more than 2.4L, there will be warning message shown on the screen, and automatically the device will be stopped.
	Faulty power status	<ul style="list-style-type: none">▪ Check ON/OFF status▪ Check connection of power cable

7. Warranty

7.1 About Warranty

1. Eunsung Global Corp. provides the following assurance for products in accordance with the Consumer Dispute Resolution Criteria by Item (Fair Trade Commission Notice).
2. Describes the free service description and the standard of service charge when using the device normally.

7.2 Guarantee against loss

1. In the event of a breakdown in normal use within one year of the date of purchase, no charge is granted..
2. The warranty covers the main body of the device. Excludes accessories such as handpiece, handpiece tip, and large waste container.

7.3 Exclusions within the Warranty Period

1. If you do not follow the operating procedures, safety and handling procedures of the equipment specified in this manual, you can not receive a free service and pay extra attention to the following
 - ① Free of charge period will be excluded when damaged by pulling on the device by pulling on the hand piece or connecting cable etc.
 - ② Exclude from the free service period when the operator uses, changes, or dismantles the device for other purposes than intended.

7.4 Compensatory guarantees

1. The warranty for payment is enforced one year after the equipment is purchased. The warranty covers the value of the product or other natural disasters (fire, salt damage, shock, earthquake, lightning, etc.), even within the warranty period.
2. The payment guarantee is as follows
 - ① Damage to the device due to careless handling (flooding, breakage, etc.) or removal or modification of the device or use by the consumer arbitrarily.
 - ② Device damage due to repair by a third party other than service personnel authorized by Eunsung global corp.
 - ③ Damage to equipment due to non-consistent of consumables usage and use method not specified in the Eunsung global lung.
 - ④ When the life expectancy limit of accesorries set by Eunsung global corp. is expired.



CAUTION

Free warranty must be obtained by service personnel qualified by Eunsung global corp. If the device is not used according to its original use, it can be excluded for free warranty period. There for should read and remember all the information in this manual..

8. Product specifications

Type	Vacuum, Electroporation, Diamond peeling
Input Power	100-132V / 200-240 V~, 50/60 Hz
Panel	7inch touch screen
Dimension (WxDxH mm)	330 X 425 X 1060mm
Weight	32kg

9. Customer services / Sales

Producer



Manufacturer : Eunsung Global Corp.
Country of manufacture : Korea
Head office :
120, Gieopdosi-ro, Gagok-ri, Wonju-si, Gangwon-do, Republic of Korea.
Tel. +82)33-760-9713 / Fax. +82)33-746-9716
Seoul office :
#1102~1105, 53, Gasan digital 2-ro, Geumcheon-gu, Seoul, 153-706,Korea
Tel: +82)2-514-9713(Rep) Fax: +82)2-514-9716
e-mail: es@esglobal.co.kr/www.esglobal.co.kr

